



6 Ascot Park Blythewood Lane, Ascot, Berkshire, SL5 8EP
£225,000

 **HORLER**

6 Ascot Park Blythewood Lane, Ascot, Berkshire, SL5 8EP

Delightful 2 bed unit park home located on Ascot Park, Blythewood Lane. Offering a spacious living/dining area, modern kitchen, 2 good size bedrooms and bathroom. With an easy to maintain garden and off road parking for 3 vehicles, why not call for a viewing today on 01753 621234.



Property Summary

Nestled in the charming residential area of Ascot Park, this delightful two-bedroom mobile home on Blythewood Lane offers a perfect blend of comfort and convenience. The property features a spacious living and dining area, ideal for both relaxation and entertaining. The modern kitchen is well-equipped, making meal preparation a pleasure.

The two generously sized bedrooms come complete with fitted wardrobes, providing ample storage space. The family bathroom is thoughtfully designed, catering to all your needs. Outside, you will find an easy-to-maintain garden, perfect for enjoying the outdoors without the hassle of extensive upkeep. Additionally, the property boasts off-road parking for up to three cars, ensuring that parking is never a concern.

This mobile home presents an excellent opportunity for those seeking a tranquil lifestyle in a sought-after location. With its modern amenities and welcoming atmosphere, it is sure to appeal to a variety of buyers. For viewings, please do not hesitate to call us today on 01753 621234.

General Information

Site Fees TBC

No Dogs allowed

Over 45s only

Council Tax Band 'A'

Legal Note

Although these particulars are thought to be materially correct their accuracy cannot be guaranteed and they do not form part of any contract.





Ascot Park

Approximate Gross Internal Floor Area = 58.5 sq m / 630 sq ft

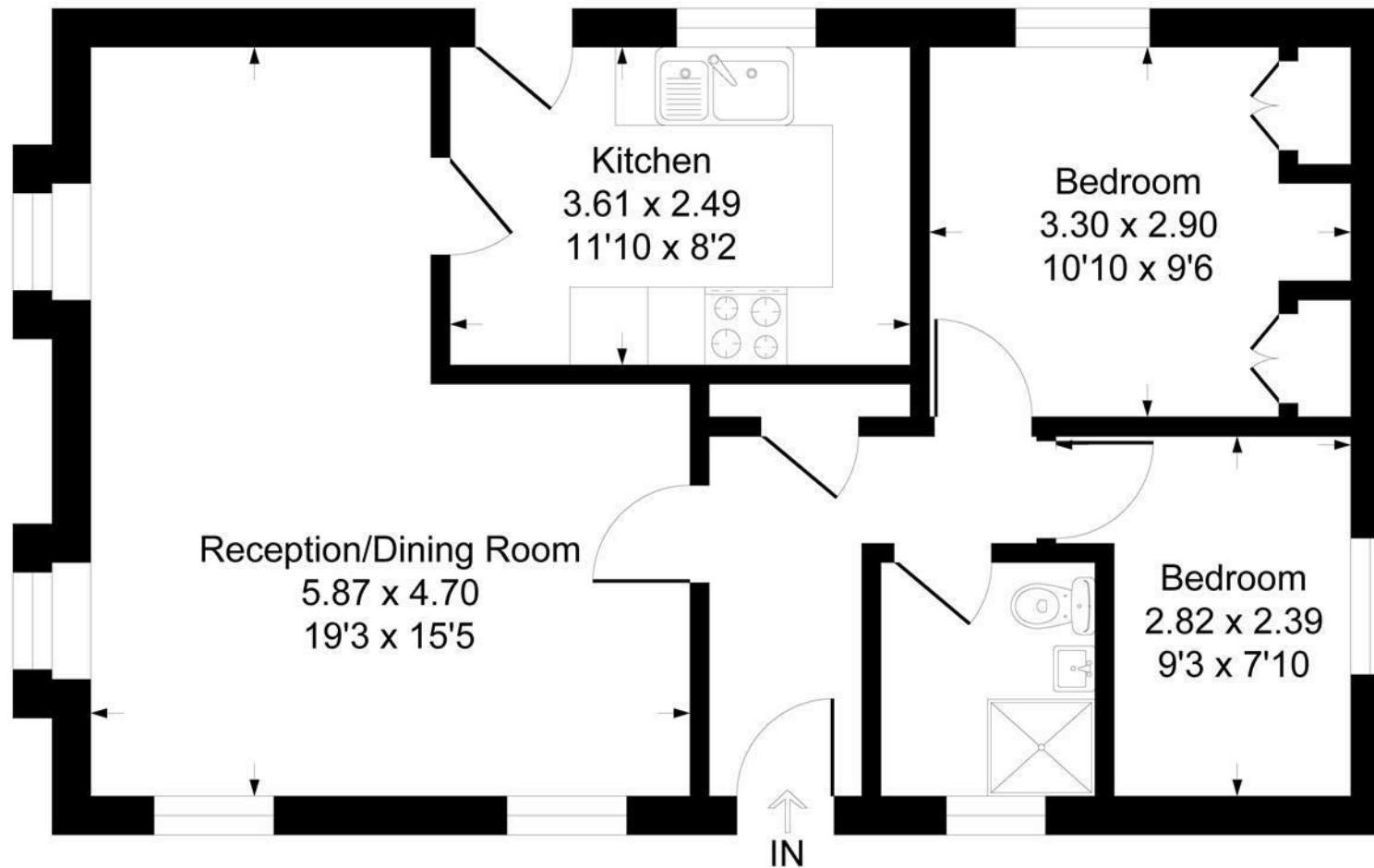

Illustration for identification purposes only, measurements are approximate, not to scale.
Produced By Esjay Property Marketing